



TOWN OF PEACE RIVER

Main Street Concrete Repair - Phase 1

2023 Design Drawings



SITE PLAN
Scale 1:4000

**NOT FOR
CONSTRUCTION**

Developer:	TOWN OF PEACE RIVER
Consultant:	BEARSTO & ASSOCIATES ENGINEERING LTD.
Underground:	
Road Works:	
Start Date:	
Completion Date:	
No. of Lots:	N/A
No. of Drawings:	4

REVISIONS		
#	COMMENTS	DATE
1	FOR DISCUSSION PURPOSES ONLY	July 11, 2023
2	ISSUED FOR TENDER	July 28, 2023
3		
4		
5		
6		

Beirsto & Associates
ENGINEERING & SURVEY | 60 YEARS

• Grande Prairie • Calgary •
• Canmore • Edmonton •
P: 780 532 4919 www.baseng.ca

COPYRIGHT 2023 BEARSTO & ASSOCIATES ENGINEERING LTD.

A:\Web\2023\23GEME6029\Drawings\1 - Drawings\0101.dwg, 7/27/2023 7:40:52 AM, MHA

LIST OF DRAWINGS

CO-01 COVER SHEET
G-01 DRAWING SET INFORMATION

OVERALL CONSTRUCTION PLANS

SP-01 SITE PLAN 100 ST - 99 AVE TO 101 AVE
OU-01 OVERALL UTILITIES 100 ST - 99 AVE TO 101 AVE

ABBREVIATIONS

AB	AGGREGATE BASE
AC	ACRES
ACP	ASPHALTIC CONCRETE PAVEMENT
APPROX	APPROXIMATE
AQ	AQUATERA
AT	ALBERTA TRANSPORTATION
AVE	AVENUE
BC	BEGINNING OF CURVE
BLVD	BOULEVARD
BOP	BEGINNING OF PLAN/PROFILE
CB	CATCH BASIN
CBMH	CATCH BASIN MANHOLE
CI	CAST IRON
CIP	CAST IRON PIPE
CL	CENTERLINE
CONC	CONCRETE
CSP	CORRUGATED STEEL PIPE
CY	CUBIC YARD
CW	COMPLETE WITH
DESC	DESCRIPTION
DIA	DIAMETER
DIP	DUCTILE IRON PIPE
E	EAST
EC	END OF CURVE
EL	ELEVATION
EOP	END OF PLAN/PROFILE
EX	EXISTING
FH	FIRE HYDRANT
F&C	FRAME AND COVER
GBC	GRANULAR BASE COURSE
HYD	HYDRANT
ID	IDENTIFICATION
INV	INVERT
MAX	MAXIMUM
MH	MANHOLE
MIN	MINIMUM
MONO	MONOLITHIC
N	NORTH
NTS	NOT TO SCALE
NO	NUMBER
OD	OUTSIDE DIAMETER
PC	POINT OF CURVATURE
PCC	POINT OF COMPOUND CURVATURE
PR	PROPOSED
PT	POINT OF TANGENCY
PVC	POLYVINYL CHLORIDE
PVI	POINT OF VERTICAL INTERSECTION
R	RADIUS
RCP	REINFORCED CONCRETE PIPE
RP	RADIUS POINT
REV	REVISION
RGS	RIGID STEEL
RD	ROAD
S	SOUTH
SALV	SALVAGE
SAN	SANITARY
SHT	SHEET
STA	STATION
STM	STORM
ST	STREET
TRM	TURF REINFORCEMENT MATTING
TYP	TYPICAL
VIR	VIDEO INSPECTION RISER
W	WEST
WTM	WATERMAIN

LINETYPE & SYMBOLS

	EXISTING	PROPOSED
SANITARY		
WATER		
STORM		
POWER		
OVERHEAD POWER		
GAS		
HIGH PRESSURE GAS		
TELUS		
DUCT		
TELUS - FIBRE OPTIK		
CITY - FIBRE OPTIK		
COMMUNICATIONS		
DITCH - BACKSLOPE		
DITCH - CENTERLINE		
DITCH - TOE		
SWALE		
UTILITY LOT BARRIER		
FENCE		
FENCE - BOLLARD		
FENCE - CHAINLINK		
FENCE - WOOD		
FENCE - SILT		
CONTOURS		
DISTURBED GROUND EXTENTS		
SPOT ELEVATIONS		
ROADWAY BARRICADE		
MANHOLE / CATCHBASIN		
HYDRANT		
MAIN WATER VALVE		
AIR RELEASE VALVE		
SERVICE WATER VALVE		
BLOW-OFF VALVE		
VIDEO INSPECTION RISER/CLEANOUT		
SERVICE RISER		
INSULATED PIPE/SERVICE		
SERVICE INVERT		
STREET LIGHT		
PEDESTAL		
TRANSFORMER		
JUNCTION BOX		
VAULT / TELUS MANHOLE		
POWER POLE		
STREET SIGN		
TREE		
BOREHOLE		
SIDEWALK RAMP		
SIDEWALK RAMP TYPE		

MATERIALS KEY

	EXISTING	PROPOSED
CONCRETE		
GRAVEL		
BRICK		
ASPHALT		
ACP MILL		
ACP OVERLAY		
FULL DEPTH RECLAMATION (FDR)		
FULL RECONSTRUCTION		
LANDSCAPE AREA		
CONCRETE SPOT REPLACEMENT		

NOTES

GENERAL

- ONLY "ISSUED FOR CONSTRUCTION" DRAWINGS ONCE SIGNED AND SEALED CAN BE USED FOR CONSTRUCTION.
- DRAWINGS ARE NOT TO BE SCALED FOR DETAILED MEASUREMENTS.
- VERIFY ALL DIMENSIONS, DATUMS, AND LEVELS PRIOR TO COMMENCEMENT OF WORK. REPORT ANY DISCREPANCIES OR OMISSIONS TO THE DESIGNER IMMEDIATELY.
- INFORMATION ON THIS DRAWING WHICH PERTAINS TO EXISTING STRUCTURES MAY BE INCOMPLETE OR IN ERROR. THE CONTRACTOR SHALL VERIFY ALL SUCH INFORMATION PRIOR TO THE START OF CONSTRUCTION.
- ALL CONSTRUCTION SHALL BE IN ACCORDANCE WITH THE TOWN OF PEACE RIVER MINIMUM DESIGN STANDARDS (2015) AND CITY OF GRANDE PRAIRIE DESIGN/CONSTRUCTION MANUAL (2022) UNLESS OTHERWISE NOTED.
- THE CONTRACTOR SHALL HAVE ALL ABOVE GROUND AND UNDERGROUND UTILITIES AND PIPELINES LOCATED PRIOR TO CONSTRUCTION.

DEEP UTILITIES

- ALL EXISTING T INFRASTRUCTURE LOCATED WITHIN THE PHASE BOUNDARY TO BE INSPECTED PRIOR TO CONSTRUCTION, AND AS PART OF THE CCC INSPECTION.
- ALL EXISTING TOWN OF PEACE RIVER INFRASTRUCTURE REQUIRING ADJUSTMENT TO NEW GRADES TO BE COMPLETED AS PER TOWN OF PEACE RIVER GENERAL MUNICIPAL SERVICING STANDARDS (2009) AND WILL ALSO BE INSPECTED AT FAC.
- ALL WORK TO BE COMPLETED TO TOWN OF PEACE RIVER GENERAL MUNICIPAL SERVICING STANDARDS (2009). CONSTRUCTION DETAILS AND REQUIREMENTS TO BE FOLLOWED AS PER MANUAL.

SHALLOW UTILITY NOTES

- THE KNOWN COMPANIES, OWNERS AND OPERATORS WITH UTILITIES IN OR NEAR THE CONSTRUCTION BOUNDARY INCLUDE:

ATCO GAS: 1-780-624-4602
TOLL FREE: 1-888-420-3464
EMERGENCY: 1-877-498-9380

ATCO ELECTRIC: 1-800-662-2248
EMERGENCY: 1-800-668-5506

TELUS COMMUNICATIONS: 1-780-310-CUTS
HIT TELUS LINE: 1-780-310-2887
AB ONE CALL: 1-800-272-3447

EASTLINK: 1-888-345-1111

TOWN OF PEACE RIVER: (DEVIN BRAUN) 1-780-624-3085

- ADJUSTMENT OF UTILITIES MAY OCCUR CONCURRENTLY WITH THE PROPOSED CONSTRUCTION. DEPENDANT ON THE MAGNITUDE AND DEGREE OF ADJUSTMENTS REQUIRED. THE WORK MAY NOT BE COMPLETED UNTIL THE LATER STAGES OF CONSTRUCTION OPERATIONS. IN THAT EVENT, THE CONTRACTOR SHALL BE REQUIRED TO ARRANGE THEIR OPERATION CLEAR OF THOSE UTILITIES UNTIL THE ADJUSTMENTS ARE COMPLETE.

- THE CONTRACTOR SHALL ENSURE THAT ALL SHALLOW UTILITIES ARE PROTECTED AND/OR RESTORED AS PER THE DIRECTION OF THE SHALLOW UTILITY COMPANIES. AS SUCH, THE CONTRACTOR IS REQUIRED TO WORK CLOSELY WITH THE SHALLOW UTILITY COMPANIES THROUGHOUT THE PROJECT.

- ENSURE ALL CONDUITS PLACED AT ROAD CROSSINGS HAVE A MINIMUM OF 1.00m COVER BELOW THE LOWEST GUTTER LINE AND ARE EXTENDED 1.5m BEHIND CONCRETE.

BEIRSTO & ASSOCIATES ENGINEERING LTD.
 60 YEARS
 ENGINEERING & SURVEY
 COPYRIGHT 2023 BEIRSTO & ASSOCIATES ENGINEERING LTD.

• Grande Prairie • Calgary •
 • Canmore • Edmonton •
 P: 780 532 4919 www.baseng.ca

SEAL

NOT FOR CONSTRUCTION

PERMIT

PERMIT TO PRACTICE
BEIRSTO & ASSOCIATES ENGINEERING LTD.

RM SIGNATURE:

RM APEGA ID #: 81974

DATE: July 27, 2023

PERMIT NUMBER: P243
The Association of Professional Engineers and Geoscientists of Alberta (APEGA)

5		
4		
3		
2	ISSUED FOR TENDER	July 28, '23
1	FOR DISCUSSION PURPOSES ONLY	July 11, '23

TECHNOLOGIST / TECHNICIAN: M. Lazanuk	
DESIGNER:	I. Matyka, P. Eng.
REVIEWED BY:	K. Gramlick, P. Eng.
RESPONSIBLE ENGINEER:	K. Gramlick, P. Eng.
DATE:	July 2023
SCALE:	N/A

PROJECT NO. 23GEME029

PROJECT NAME
MAIN STREET CONCRETE REPAIR - PHASE 1

DRAWING DESCRIPTION
DRAWING SET INFORMATION

DRAWING NO. G-01

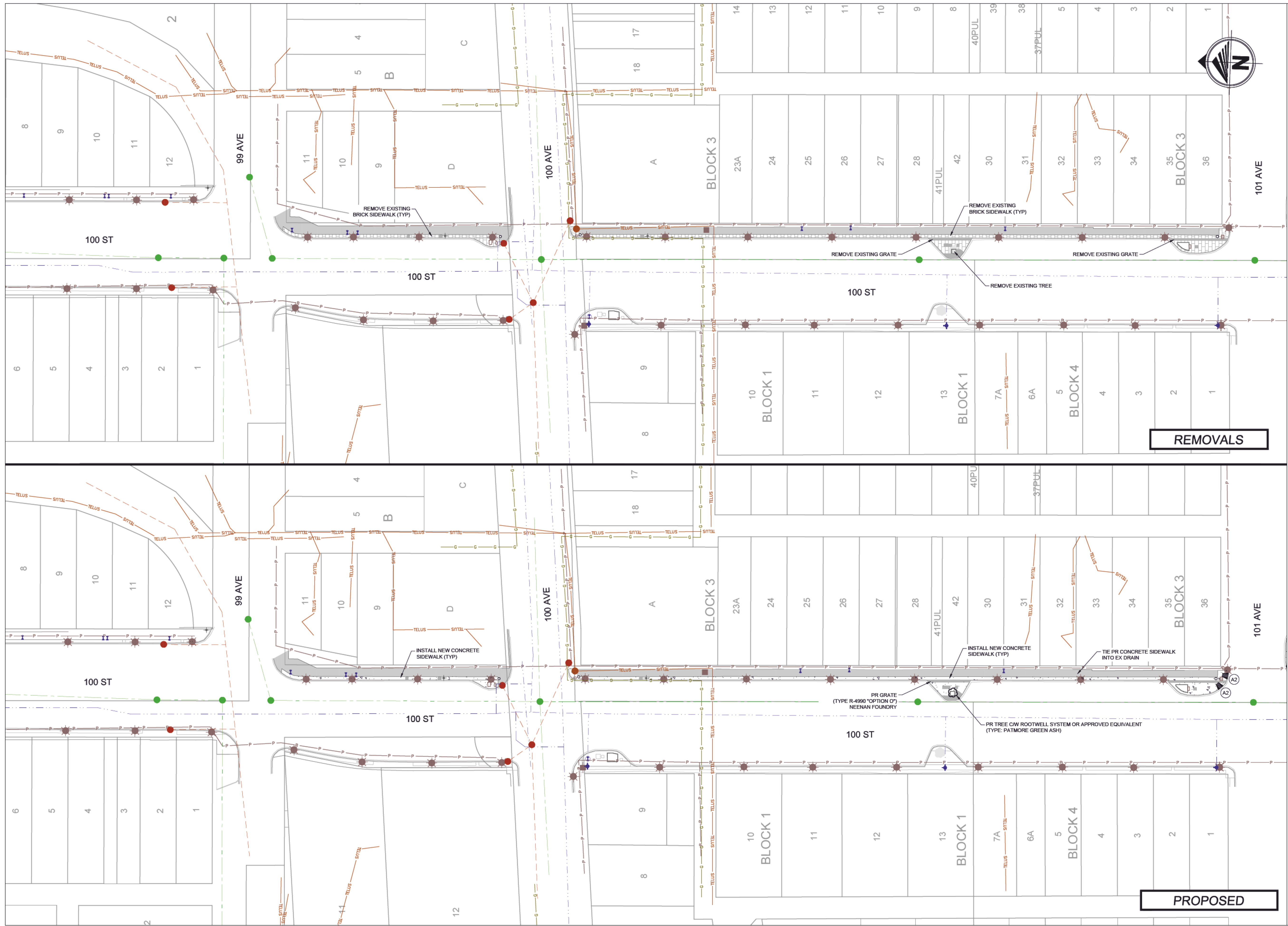

• Grande Prairie • Calgary •
 • Canmore • Edmonton •
 P: 780 532 4919 www.baseng.ca

Beirsto & Associates 60 YEARS
 ENGINEERING & SURVEY



NOT FOR CONSTRUCTION

PERMIT
PERMIT TO PRACTICE
 BEARSTO & ASSOCIATES ENGINEERING LTD.
 RM SIGNATURE: *[Signature]*
 RM APEGA ID #: 81974
 DATE: July 27, 2023
PERMIT NUMBER: P243
 The Association of Professional Engineers and Geoscientists of Alberta (APEGA)

5	
4	
3	
2	ISSUED FOR TENDER July 28, '23
1	FOR DISCUSSION PURPOSES ONLY July 11, '23

TECHNOLOGIST / TECHNICIAN:	M. Lazanuk
DESIGNER:	I. Matyka, P. Eng.
REVIEWED BY:	K. Gramlick, P. Eng.
RESPONSIBLE ENGINEER:	K. Gramlick, P. Eng.
DATE:	July 2023
SCALE:	1:500

PROJECT NO. 23GEME6029

PROJECT NAME
MAIN STREET CONCRETE REPAIR - PHASE 1

DRAWING DESCRIPTION
SITE PLAN 100 ST - 99 AVE TO 101 AVE

DRAWING NO. **SP-01**

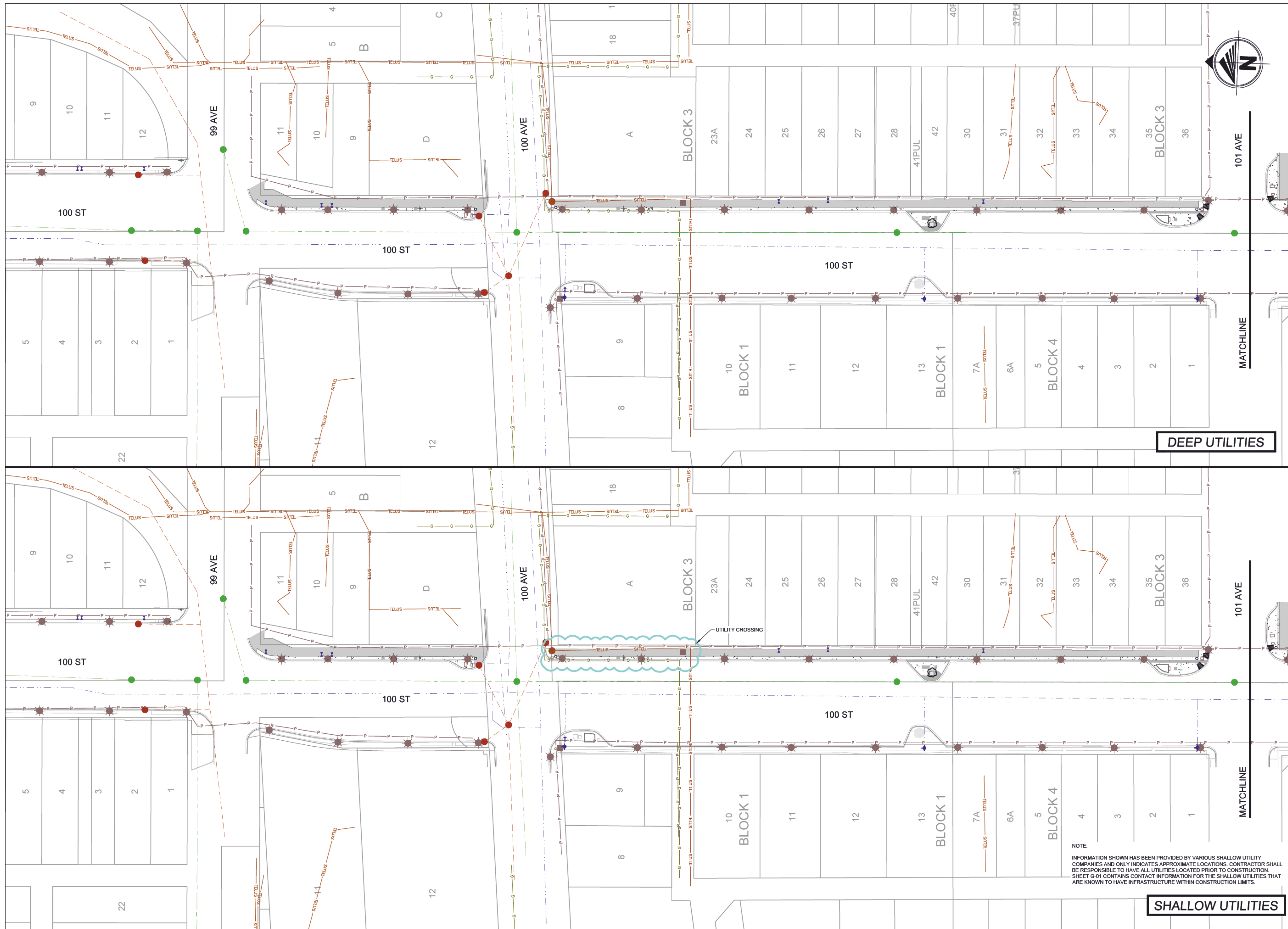

• Grande Prairie • Calgary •
 • Canmore • Edmonton •
 P: 780 532 4919 www.baseng.ca

Bearsto & Associates 60 YEARS
 ENGINEERING & SURVEY
Copyright 2023 BEARSTO & ASSOCIATES ENGINEERING LTD.



NOT FOR CONSTRUCTION

PERMIT
PERMIT TO PRACTICE
 BEARSTO & ASSOCIATES ENGINEERING LTD.
 RM SIGNATURE: *I. Matyka*
 RM APEGA ID #: 81974
 DATE: July 27, 2023
PERMIT NUMBER: P243
 The Association of Professional Engineers and Geoscientists of Alberta (APEGA)

5		
4		
3		
2	ISSUED FOR TENDER	July 28, '23
1	FOR DISCUSSION PURPOSES ONLY	July 11, '23

TECHNOLOGIST / TECHNICIAN: M. Lazanek	
DESIGNER:	I. Matyka, P. Eng.
REVIEWED BY:	K. Gramlick, P. Eng.
RESPONSIBLE ENGINEER:	K. Gramlick, P. Eng.
DATE:	July 2023
SCALE:	1:500

PROJECT NO. 23GEME6029

PROJECT NAME
MAIN STREET CONCRETE REPAIR - PHASE 1

DRAWING DESCRIPTION
OVERALL UTILITIES 100 ST - 99 AVE TO 101 AVE

DRAWING NO. **OU-01**

DEEP UTILITIES

SHALLOW UTILITIES

NOTE:
INFORMATION SHOWN HAS BEEN PROVIDED BY VARIOUS SHALLOW UTILITY COMPANIES AND ONLY INDICATES APPROXIMATE LOCATIONS. CONTRACTOR SHALL BE RESPONSIBLE TO HAVE ALL UTILITIES LOCATED PRIOR TO CONSTRUCTION. SHEET G-01 CONTAINS CONTACT INFORMATION FOR THE SHALLOW UTILITIES THAT ARE KNOWN TO HAVE INFRASTRUCTURE WITHIN CONSTRUCTION LIMITS.